

EIGHT UNIT WAREHOUSE BLOCK D1-D8A

George Town Centr, Seven Mile Beach, Cayman Islands

MLS# 416178

CI\$4,200,000

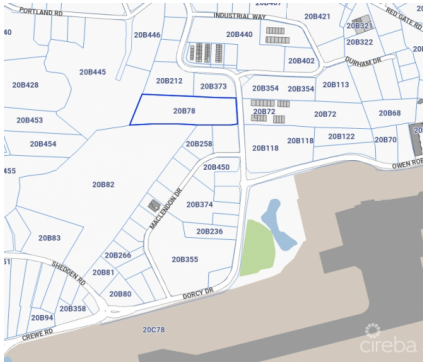



Kerri Kanuga
345-916-7020
kerri@tridentproperties.ky

There is a rare opportunity to purchase a brand new warehouses, block of eight units located in the heart of Industrial Park, on Dorcy Drive, in close proximity to the airport. The warehouse, units are D1-D8, The units are currently under construction and have a completion date of Fall 2023. At approximately 1,250 each unit and a total of 10,000 square feet, these unit has fire-rated dividing walls and is fitted with life safety fire alarms, smoke detectors and a sprinkler system. These ensure the safety of all the unit's possessions and belongings at all times. The building structure itself is constructed with steel and concrete and designed to withstand 150mph winds in the event of a hurricane occurring. Similarly, the roof panels are 26 gage galvalume on steel purlins, which guarantees the roof remains strong over long periods and unpredictable events. Distinctly, the front of this unit has an electric shutter system which allows easier access to your unit when moving larger or more fragile items. The unit could have a mezzanine (2nd floor within the unit) installed after construction is completed, which would allow you to optimize vertical space and make your unit customizable. The unit is fitted with a restroom with a toilet, sink and extract fan. This storage space is in a fantastic location with its close proximity to the airport and surrounding businesses. Due to the new exciting extension plan for Owen Roberts International Airport, as well as the new by-pass leading from Camana Bay to the airport, this storage space will not only be simpler to access in terms of its location but will also become a sought-after asset. Storage is a very worthwhile investment, on an island as small as Grand Cayman. How do you want to live your life?

Essential Information

Type	Status	MLS	Listing Type
Commercial (For Sale)	Current	416178	Warehouse

Key Details

Block & Parcel	Acreage	Den	Year Built
20B,78D1-D8A	2.0000	No	2023

Additional Feature

			Block
			20B
Lot Size	Parcel	Views	Foundation
2	78D1-D8A	Inland	Slab